

SLOUGH MULTIFUEL EXTENSION PROJECT

Planning Inspectorate Ref: EN010129

The Slough Multifuel Extension Order

Land at 342 Edinburgh Avenue, Slough Trading Estate, Slough

Document Ref: 7.4.3 Condition 4 – Living Wall – Maintenance and Planting Information

The Planning Act 2008



Applicant: SSE Slough Multifuel Limited

May 2023 – Deadline 5



ansglobal



Maintenance

Having successfully designed, grown and installed the ANS Living Wall System™, maintenance is essential to guarantee the wall has a fresh and vibrant appearance on an ongoing basis. ANS offer a professional maintenance contract to maintain the living wall on site. This ensures that the Living Wall grows suitably, is pruned accurately and is fed as appropriate.

Once plants have finished flowering, the dead flowers are removed and the apical dominance of the plants is kept in check. This ensures a healthy wall, aesthetically and scientifically.

Site visits are carried out as required to carry out the following work

- Visually inspect the wall
- Check the moisture levels in wall and adjust irrigation as necessary
- Check the well-being of plants
- Carry out remedial work to wall as found to be necessary
- Remove weeds
- Prune in accordance with seasonal requirements
- Dead head as necessary
- Treat for pest and disease
- Apply feed and nutrient as necessary
- Check and service irrigation plant and ensure correct operation
- Sweep and tidy below wall
- Check run off outlets for blockage
- Replant at any plants that have failed due to poor workmanship

The ANS promise is that with our maintenance programme in place the living wall will be kept in its original pristine condition.



ANS Living Wall System

The ANS Living Wall System™ is renowned globally for its proven unique modular technology, creating impressive vertical plantations.

The ANS Living Wall System™ is made from 100% recycled material incorporating organically grown media which encourages longevity of the planting.

This proven modular system can be built up and around any structure, to any size - a living work of art professionally designed and delivered to site fully planted to give instant full impact.

The system incorporates a fully automatic irrigation system to allow every area of the wall to have the correct amount of water.

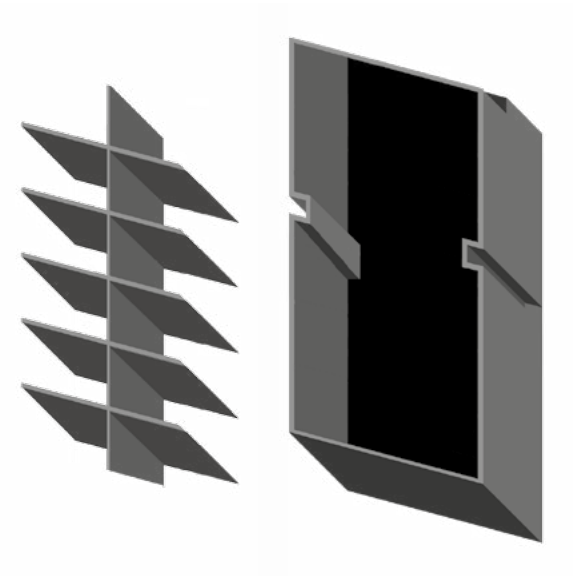

Installation



Indicative brick or concrete surface.

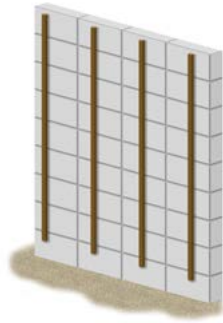

Add FSC treated softwood batons

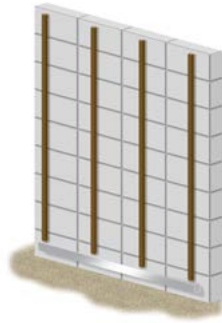

Install drainage channel of choice.

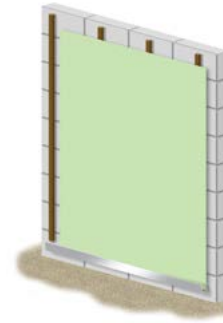

Fit breathable waterproof membrane



Add bespoke hanging rails

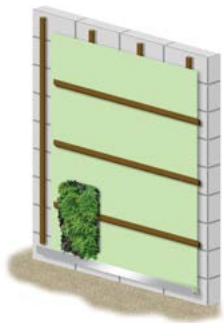

Place pre-grown and fully established ANS LivingWall modules



Complete first row



Install irrigation pipe on first row of modules



Build the living wall up layer by layer. Each module is planted to give desired effect.



Finished wall connected to irrigation system.

- NOTES
1. Any dimensions scaled from this drawing are taken at the readers own risk.
 2. All dimensions are in mm unless stated otherwise.
 3. Weight Loading of 72kg/m²

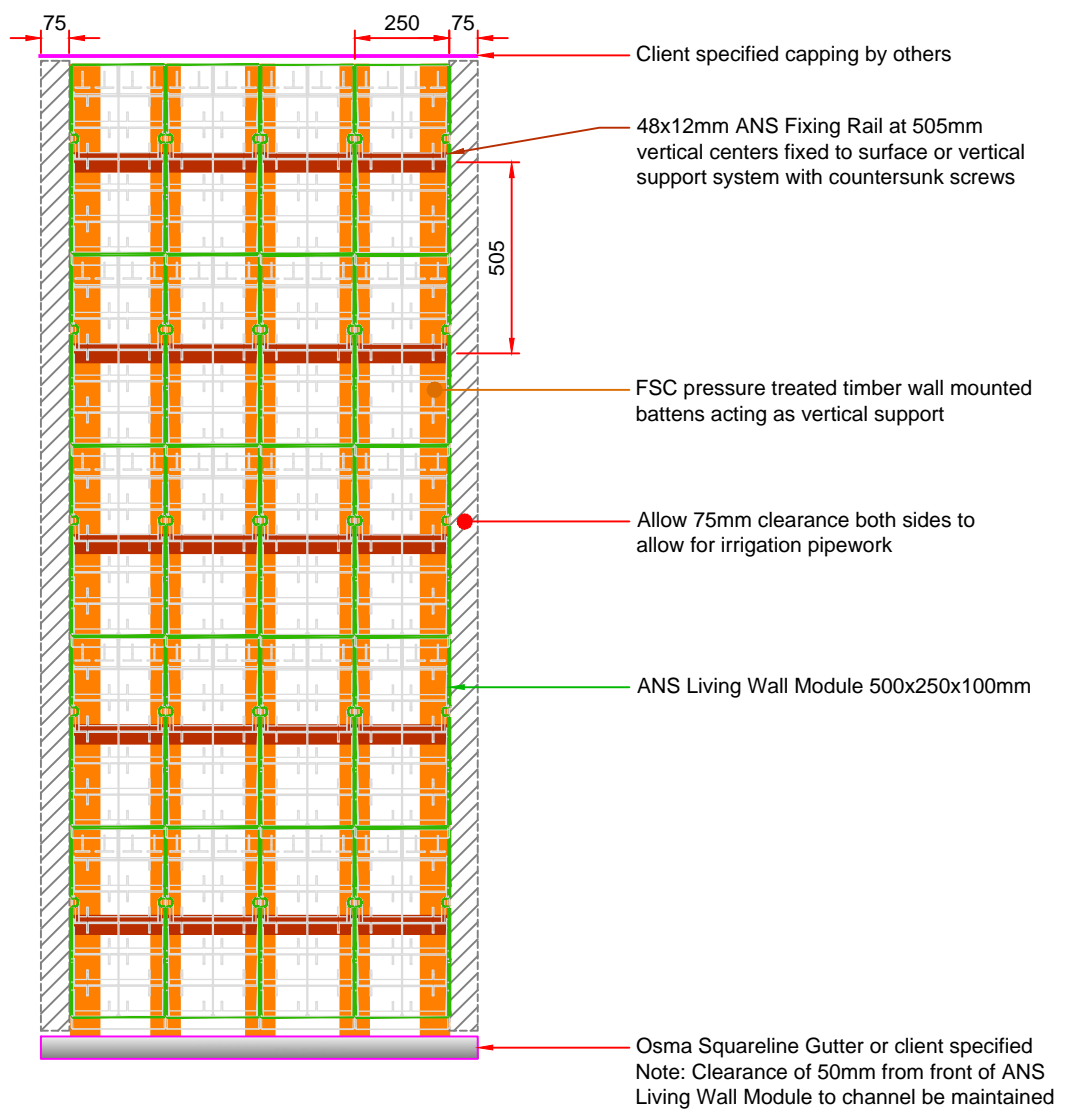

Front Elevation
Scale 1:20

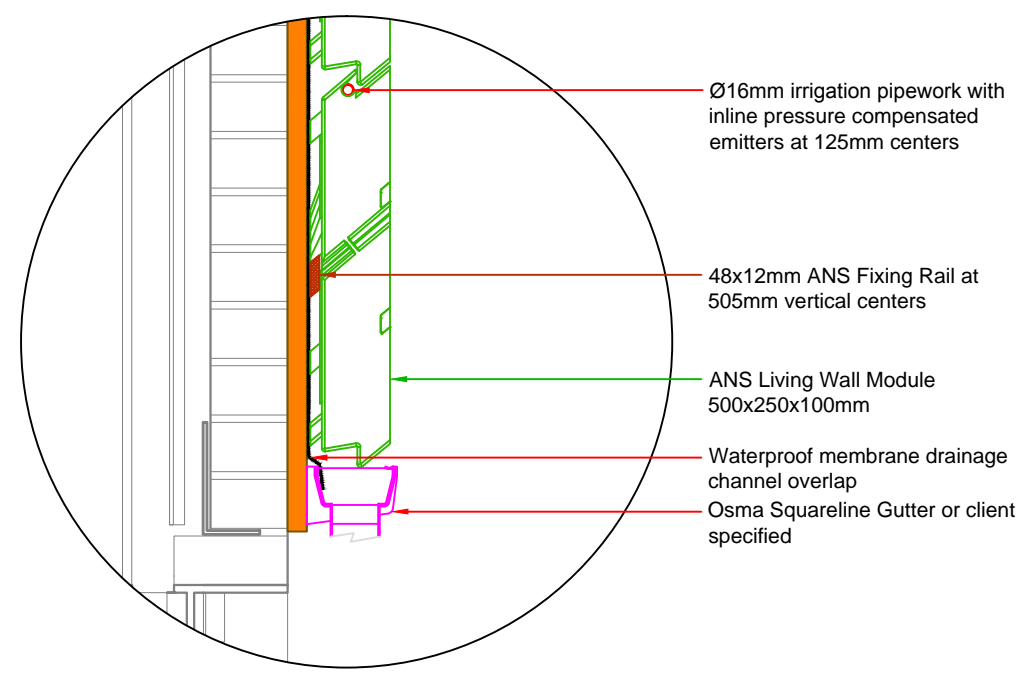

Bottom Section
Scale 1:10

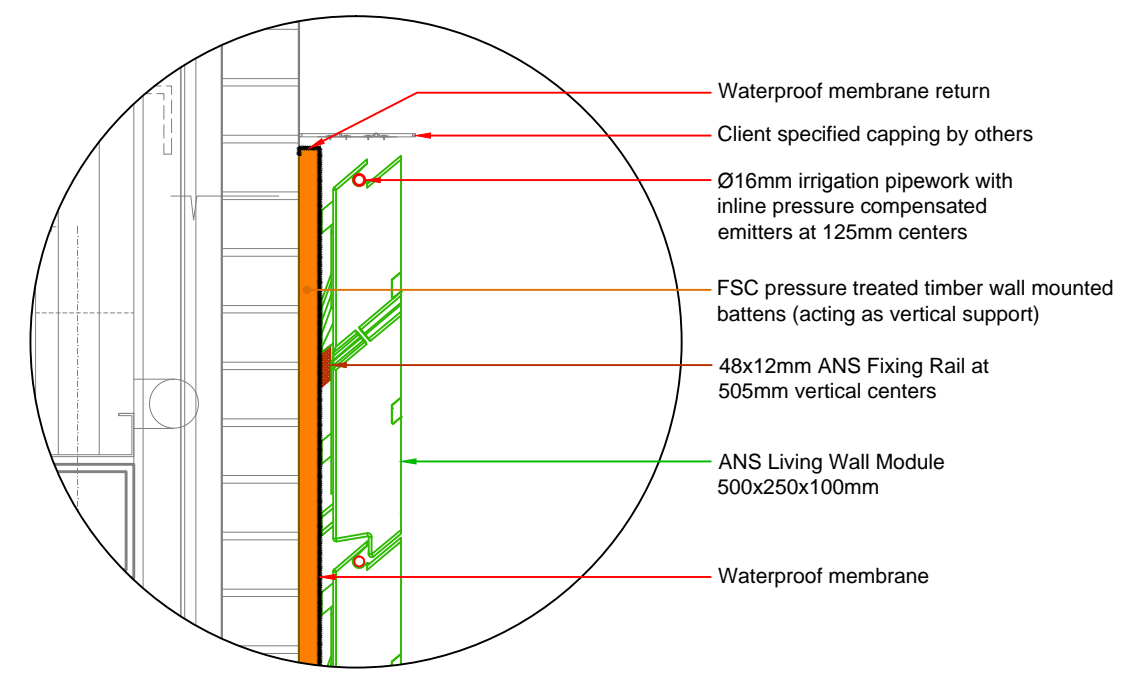

Top Section
Scale 1:10

Revision	Description	Date	Engineer



Aldingbourne Nurseries, Church Road,
Aldingbourne, Chichester, PO20 3TU
+44 (0)845 505 5555 | +44 (0)845 5055556
enquiries@ans.global | www.ansgroupglobal.com

DRAWING
ANS Living Wall Module
Sample Fixing Instructions Sheet
Solid Walls (Brick, Block, Concrete, Etc)



Steel frame installed (or existing steel frame)



Add FSC treated softwood batons



Add bespoke hanging rails



Install drainage channel of choice.



Pre-grown and fully established ANS LivingWall modules



Place ANS LivingWall modules on hanging rails



Complete first row



Install irrigation pipe on each row of modules



Build the living wall up layer by layer. Each module is planted to give desired effect.



Finished wall connected to irrigation system.

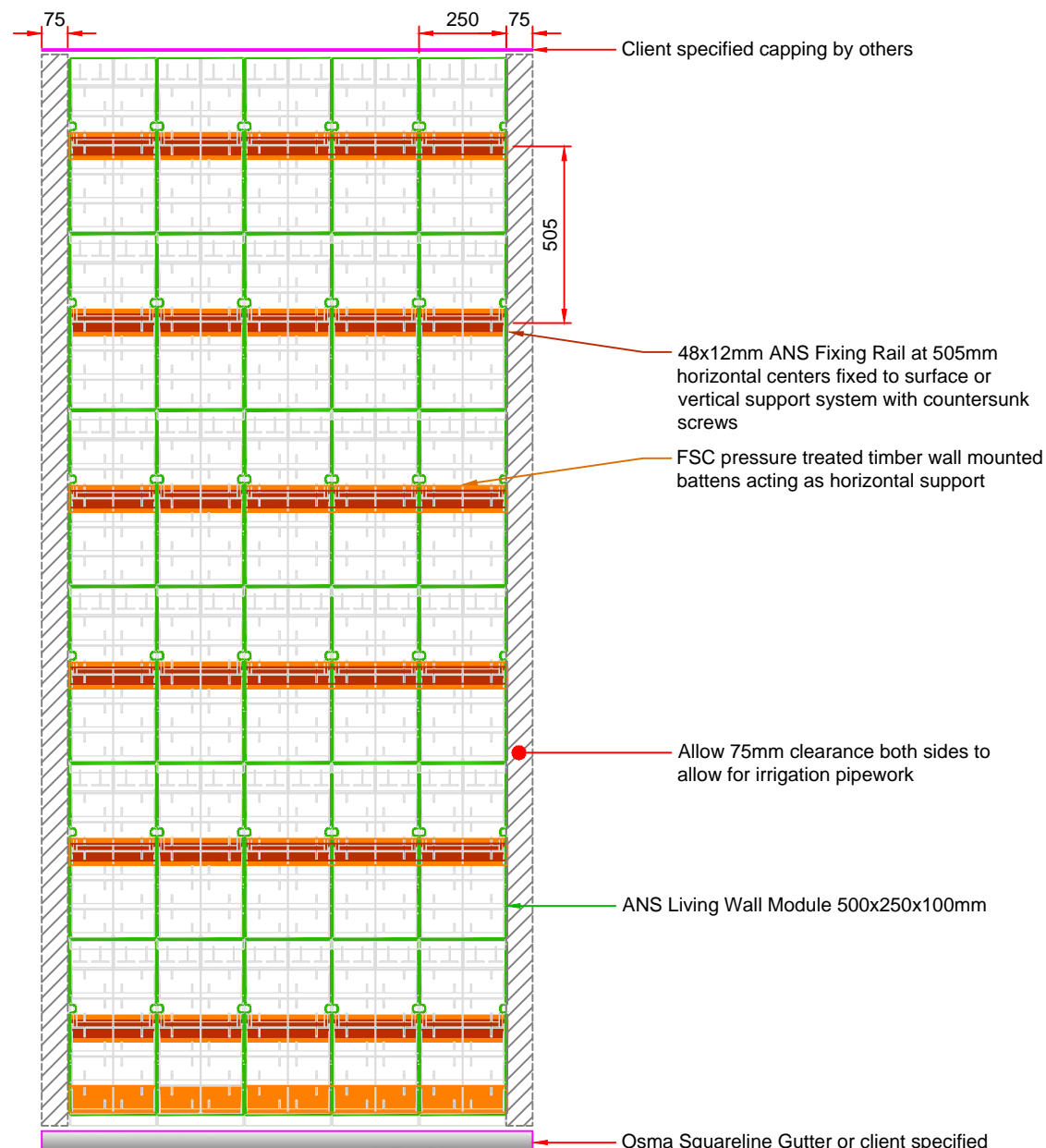

Front Elevation

Scale 1:20

Client specified capping by others

48x12mm ANS Fixing Rail at 505mm horizontal centers fixed to surface or vertical support system with countersunk screws

FSC pressure treated timber wall mounted battens acting as horizontal support

Allow 75mm clearance both sides to allow for irrigation pipework

ANS Living Wall Module 500x250x100mm

Osma Squareline Gutter or client specified
Note clearance of 50mm from front of ANS Living Wall Module to channel be maintained

- NOTES
1. Any dimensions scaled from this drawing are taken at the readers own risk.
 2. All dimensions are in mm unless stated otherwise.
 3. Weight Loading of 72kg/m²

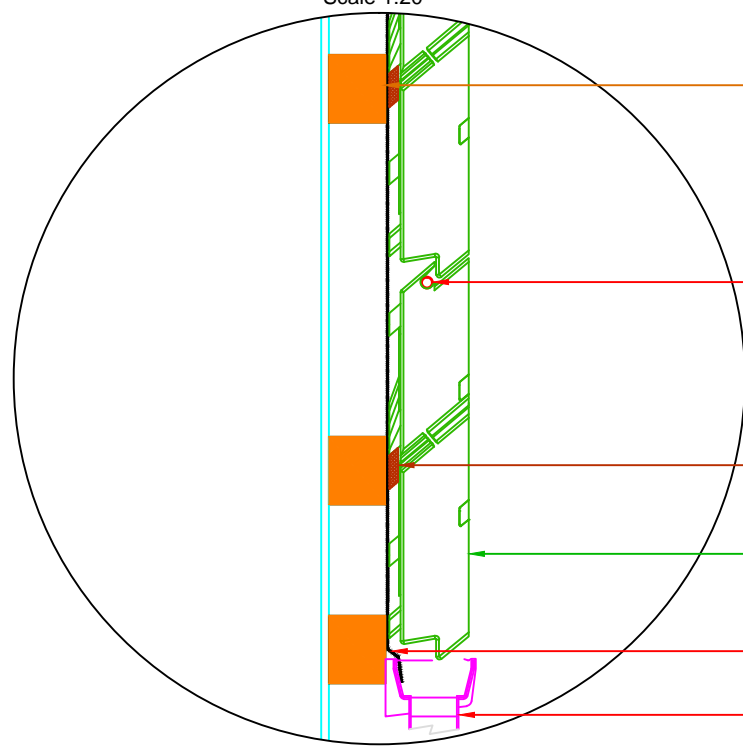

Bottom Section

Scale 1:10

FSC pressure treated timber wall mounted battens (acting as horizontal support)

Ø16mm irrigation pipework with inline pressure compensated emitters at 125mm centers

48x12mm ANS Fixing Rail at 505mm Horizontal Centers

ANS Living Wall Module 500x250x100mm

Waterproof membrane drainage channel overlap

Osma squareline gutter or client specified

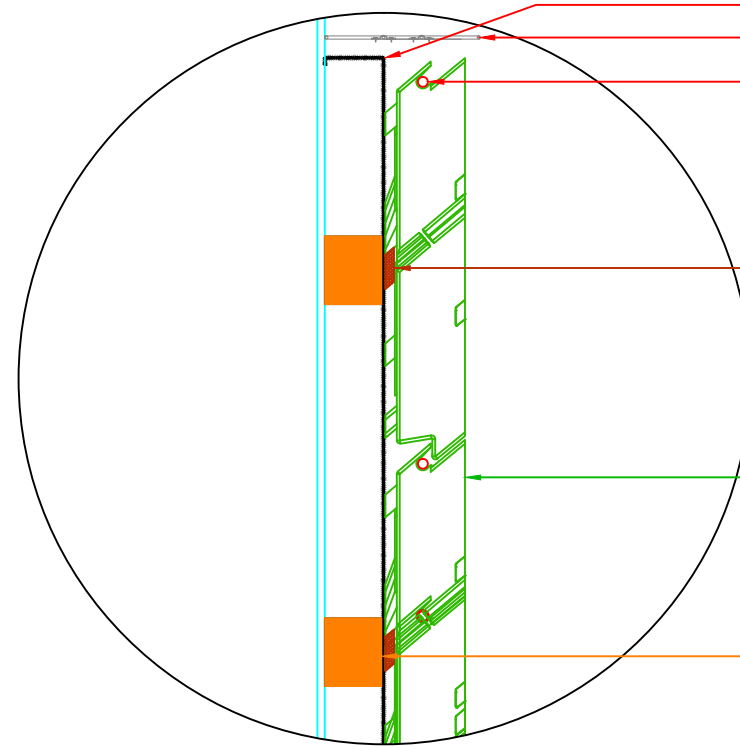

Top Section

Scale 1:10

Waterproof membrane return
Client specified capping by others

Ø16mm irrigation pipework with inline pressure compensated emitters at 125mm centers

48x12mm ANS Fixing Rail at 505mm horizontal centers

ANS Living Wall Module 500x250x100mm

FSC pressure treated timber wall mounted battens (acting as horizontal support)

Revision	Description	Date	Engineer
A	Draughtsman modifications	24.07.14	LE



Aldingbourne Nurseries, Church Road,
Aldingbourne, Chichester, PO20 3TU
+44 (0)845 505 5555 | +44 (0)845 505556
enquiries@ans.global | www.ansgroupglobal.com

DRAWING
ANS Living Wall Module
Sample Fixing Instructions Sheet
Metal Frames, Horizontal Battens

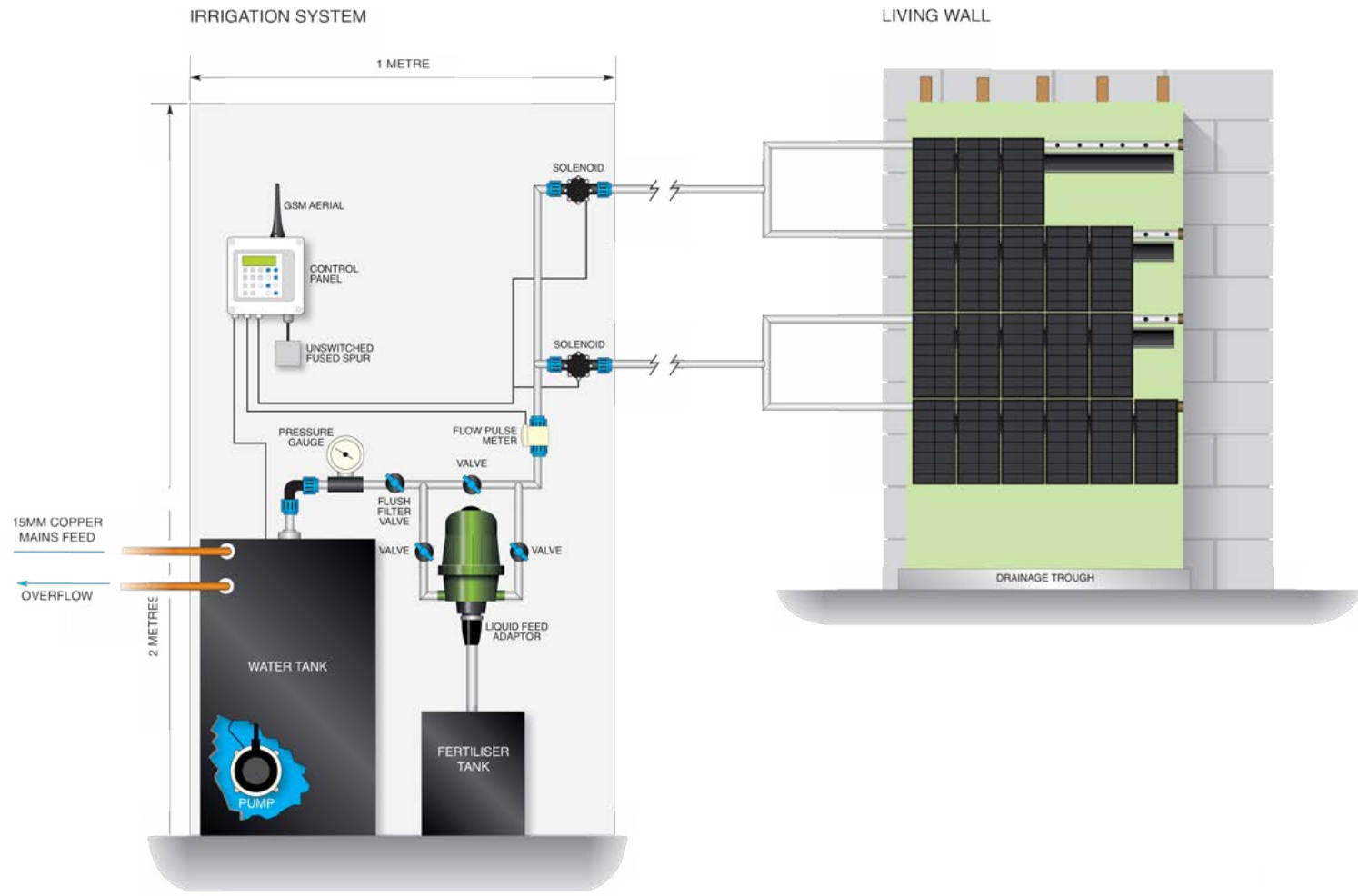

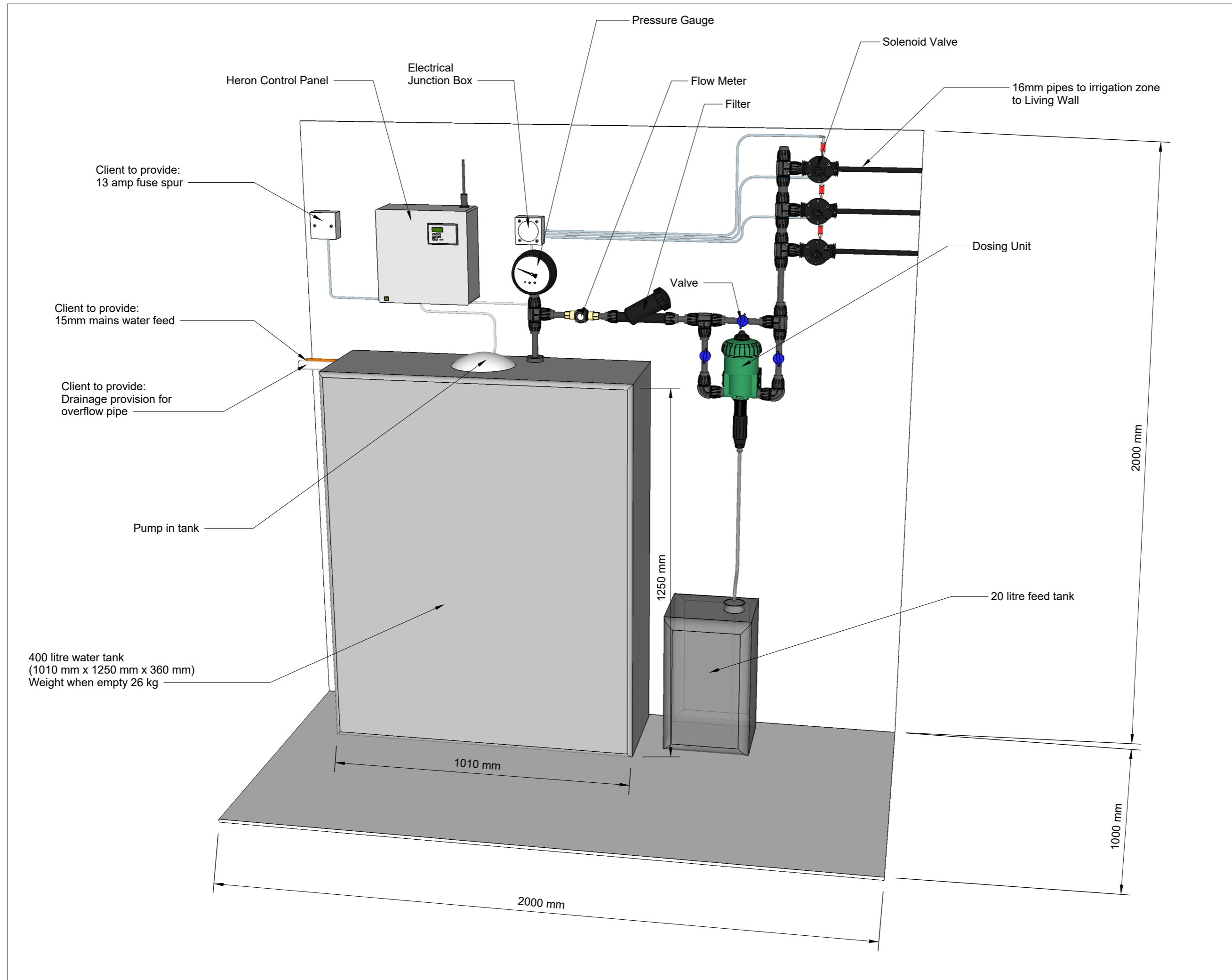

COMPANY NAME
ANS Group Global Ltd
Aldingbourne Nurseries,
Church Road,
Aldingbourne,
Chichester, PO20 3TU,
United Kingdom
+44 (0)1243 545818
enquiries@ans.global
ansgroupglobal.com

ISSUE
October 9, 2017

DRAWN BY
MRC

ANS Living Wall
Standard Plant Room
with Remote Control

A.01

Hunter Controller

This entry-level controller offers simple operation with “smart” Solar Sync compatibility. With easy-to-configure control for up to 8 stations, including 3 programs and 4 start times each, the X-Core is the perfect solution for smaller living walls. Plug in the revolutionary Solar Sync ET sensor and the X-Core is converted into a “smart controller” that regulates irrigation runtimes based on locally measured weather. X-Core controllers are designed to be simple while still delivering optimal efficiency and reliability.

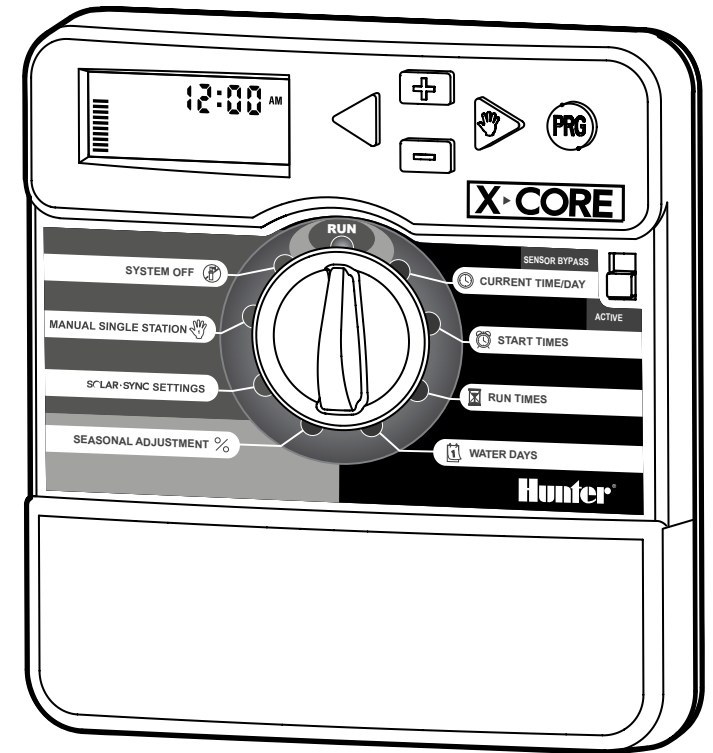

Hunter[®]

ANS Living Wall Module

THIRD ANGLE PROJECTION

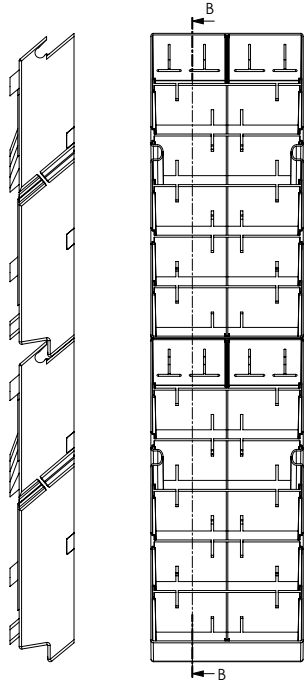

SECTION B-B
SCALE 1:3



DO NOT SCALE

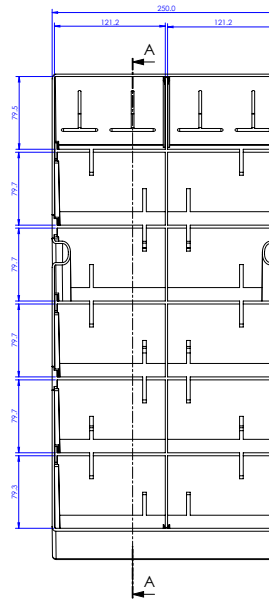
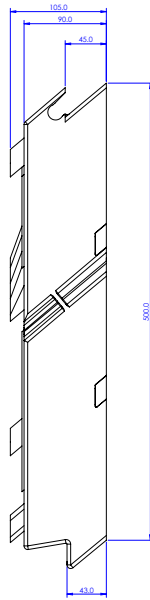
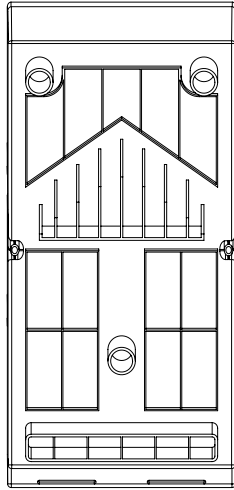

REVISIONS
DESCRIPTION

NAME DATE

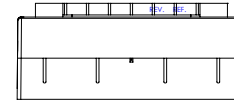

SECTION A-A

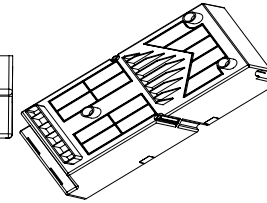
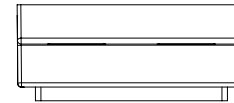
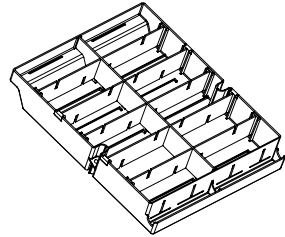
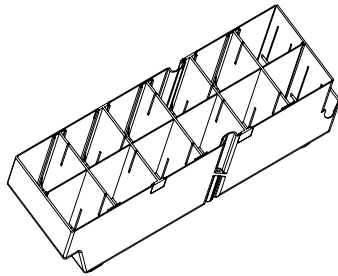
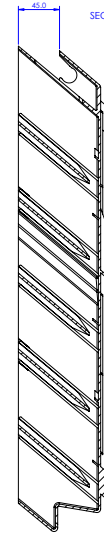

GrufeTile Specification Sheet

Key Facts

- Compressive strength 2.000 Kg/m²
- Water holding capacity of 20 litres/m²
- UV resistant
- Temperature range -50°C - 80°C
- Carrier material 100% Regenerated Polypropylene (PP)
- Carrier measures 540 x 540 x 90mm
- Drainage Surface 318 cm²/m²
- Outflow Volume 40 l/m²
- Saturated weight: Sedum 65kg/m², Others 75kg/m²
- 10 year guarantee

Your GrufeTile will be supplied with established plant coverage, growing on 60mm 100% recycled growing media. The GrufeKit has a saturated weight of 65kg per m² apart from Brown Wildflower which are 75kg per m².

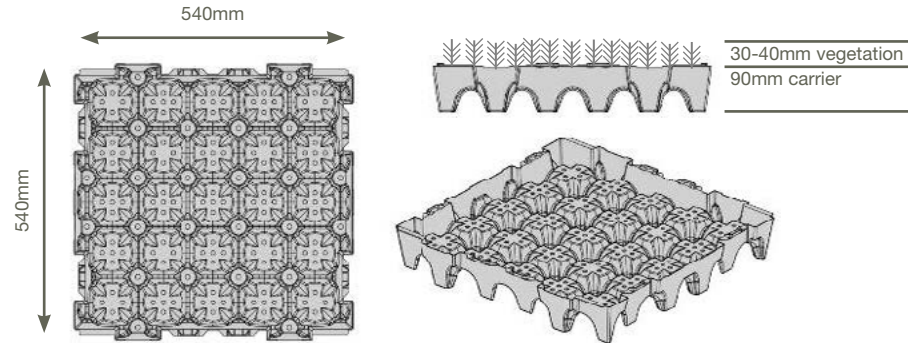

Vegetation: The Sedum GrufeTile's are pregrown with 8 -12 varieties of sedum, the Sedum & Wildflower has an additional 20-30 varieties of wildflower and meadow grasses, the Brown Wildflower has no sedum, just wildflowers and meadow grasses.

Carrier: Made from recycled HDPE plastic, and performs the following roles – a water reservoir, drainage layer, protection from excessive drying of roots from the airspace below, the cups greatly improve product handling making it easier to install



Installation: The item is equipped with a double-action coupling system: the tabs on the side of each part engage the edge in the gaps between tabs of the facing part.

Media: The media mix used is a special substrate prepared specifically for ANS, but particular mixes can also be prepared depending on the planting & project requirement.



Brown Wildflower



Sedum & Wildflower



Sedum



ANS Living Wall System

Manufacturer / Supplier:

ANS Global
Aldingbourne Nurseries
Church Road
Aldingbourne
Chichester
PO20 3TU
Tel: 0845 505 5555
Web: [REDACTED]

Product Reference: ANS Living Wall Module™

Living Wall integral components supplies by ANS:

ANS Living Wall Module™

500mm x 250mm x 100mm;
Made of high density Polyethylene (HDPE) BS 476 Part 7 1997, Class 1
80% post industrial recycled material;
UV resistant;
Temperature range -40°C to 80°C.

ANS Fixing Rails

48mm x 12mm fixed to surfaces at 500mm centres;
To be fixed to surfaces with countersunk screws, (size of which is site specific);
Made to high density Polyethylene (HDPE) BS 476 Part 7 1997, Class 1 100% post-industrial recycled material;
UV resistant;
Temperature range -40°C to 80°C.

Capping:

Product Reference: Subject to Specifier's choice and recommendations.

Drainage Channel: 107mm x 51mm gutter. (see manufacturer's specifications)

Product Reference: Osma Squareline (or equal and equivalent).

Made of PVC-U, UV resistant.

Manufacturer: <http://osma.wavin.com>

Note: Alternatives subject to Specifier's choice and recommendations.

Waterproof breathable membrane (see manufacturer's specifications):

Product Reference: Tyvek® HomeWrap® (or equal and equivalent).

Manufacturer: DuPont™ Tyvek® HomeWrap®

Web: http://construction.tyvek.co.uk/Tyvek_Construction/en_GB/products/wall/housewrap.html

Softwood battens (size of which is site specific)

To be fixed to surfaces at 250mm centres;

Pressure treated, FSC softwood only;

Timber preservative to be applied to any cut surfaces to ensure impregnability;

To be fixed to surfaces with countersunk screws, (size of which is site specific).

ANS Irrigation Unit:

Break Tank (size of which is site specific);

Dosatron® liquid feed dispenser to ensure correct feeding of wall to ensure healthy growth of plants;

Electronic programmer with various stations linked via solenoid valves to ensure an equal distribution of water through the wall;

The solenoid valves automatically water each station through the emitter pipes installed on each row of modules;

The water pressure is calibrated and adjusted to ensure the water run-off is minimal;

The small amount of run-off is directed to a box section gutter which drains into a local drain point.

ANS Living Wall Planting Media

Plant choice as selected by ANS Global to suit location and requirements.

Installation

Installation by ANS Global approved installation specialists. Details provided on request.